

This drawing is to be read in conjunction with all other contract documents and specifications and all other consultants drawings.

All levels and dimensions should be checked on site and any discrepancies notified to the Architect prior to proceeding with works.

THIS DRAWING IS COPYRIGHT.
No drawing shall be reproduced in any form without prior written permission of Eric Parry Architects.

NOTE:
Existing site & building information based on survey information drawing 4230485/4101, dated November 2023, as provided by Glanvilles

- KEY**
- Planning application boundary
 - No development proposed
 - Existing buildings
 - Site access/ egress points

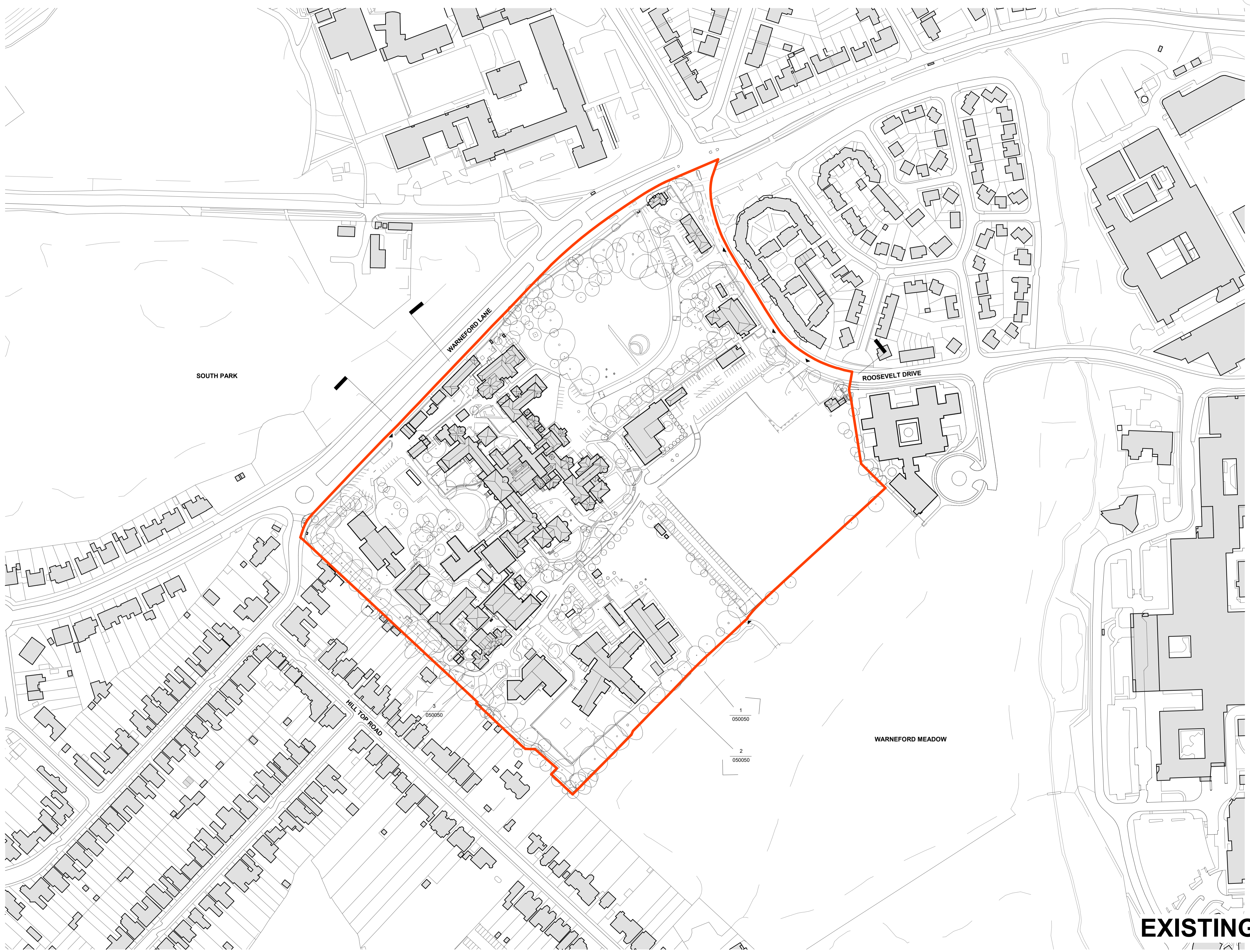

135

For Planning Approval

Rev	Description	Date	By	Chk
C00	For Planning	03/07/25	CH	JM

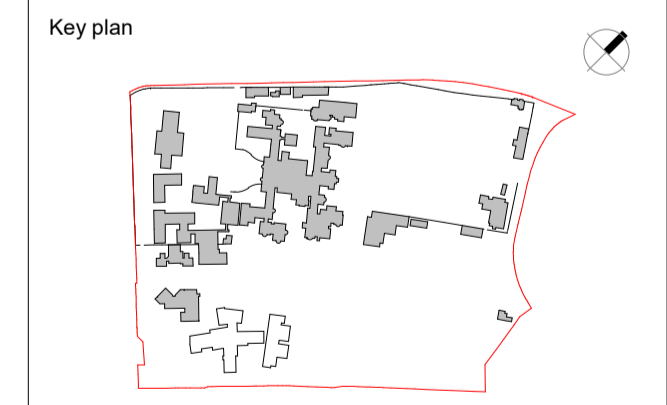

28 - 42 Banner Street
London EC1Y 8QE
Tel 020 7608 9600
Fax 020 7608 9601
www.ericparryarchitects.co.uk

Eric Parry Architects

client
Oxford Health NHS Foundation Trust

project
Warneford Park Masterplan

status description
For Planning

status code
A1

drawing title
Existing Masterplan Location Plan

scale
1:1250 @ A1

revision
C00

EXISTING



WPO-EPA-Z00-RF-DR-AR-050010

This page is intentionally left blank